

# BLUSHIELD HUMPBACK PRESSURE WASHER AMERICAN

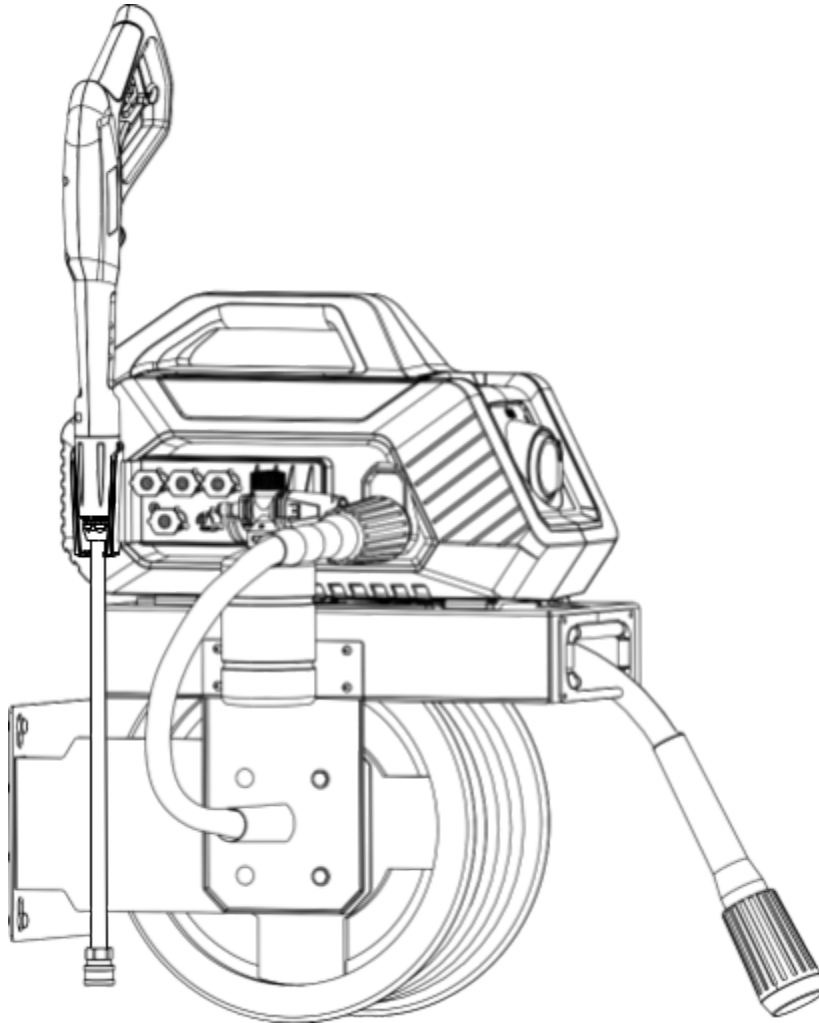

WARNING: Read the instructions before using the machine.

---



Contents

<u>Section</u>	<u>Page</u>
Important Safety Precautions, Tips	2
Warnings, and Usage Instructions	3-6
Assembly Instructions	7-9
Operating Instructions	10-12
Using Detergents	13
Clean-up and Storage	14
Cleaning Tips	15
Technical data	16
Troubleshooting Tips	17
EC Declaration	18

## IMPORTANT SAFETY TIPS

<u>Never</u> point the high-pressure nozzle at people or animals.
<u>Never</u> drink alcohol or use drugs while operating the pressure cleaner.
<u>Never</u> operate the pressure cleaner while standing in water.
<u>Never</u> touch the electrical plug with wet hands.
<u>Never</u> let electrical connections rest in water.
<u>Never</u> operate pressure cleaner without the water turned on.
<u>Never</u> use hot water with this pressure cleaner.

## IMPORTANT SAFETY PRECAUTIONS

WARNING: When using this product, basic precautions should always be followed, including the following:

1. Read all instructions before using the product. Save all safety instructions.
2. Do not operate the pressure cleaner when fatigued or under the influence of alcohol or drugs.
3. Risk of injection or injury - do not direct the high pressure water stream at any people or animals.
4. Do not allow children to operate the pressure cleaner at any time.
5. To reduce the risk of injury, close supervision is necessary when the pressure cleaner is used near children.
6. Know how to stop the unit and reduce pressure immediately. Be completely familiar with the controls.
7. Stay alert - always be aware of where you are directing the high pressure spray
8. Keep cleaning area clear of all people.
9. Keep good footing and balance at all times - do not overreach or stand on an unstable support.
10. The work area should have adequate drainage to reduce the possibility of a fall due to slippery surfaces.
11. Follow the maintenance instructions specified in the manual.
12. To reduce the risk of electrocution, keep all connections dry and off the ground. Do not touch plug with wet hands.





## GENERAL SAFETY PRECAUTIONS

1.	Intended for outdoor household use only.
2.	High-pressure hose can develop leaks from wear, abuse, kinking etc. Do not use a



	damaged hose.
3.	Do not use the pressure cleaner in areas near combustible materials, combustible fumes, or dust.
4.	Some chemicals or detergents may be harmful if inhaled or ingested causing severe injury. Use a respirator or mask whenever there is a chance that vapors may be inhaled. Read all instructions included with the mask so you are certain the mask will provide the necessary protection against inhaling harmful vapors.
5.	Before starting the pressure cleaner in cold weather, check all of the parts of the equipment and be sure that ice has not formed. Do not store the unit anywhere that the temperature will fall below 0° C (32° F).
6.	Do not make any modifications to any of the components! Units with broken or missing parts, or without the protective housing or covers should never be operated
7.	Keep the high-pressure hose connected to the pressure cleaner and the spray gun while the system is pressurized. Disconnecting the hose while the unit is pressurized is dangerous, and may cause injury.
8.	Do not leave the pressure cleaner unattended while the power switch is ON.
9.	Keep water spray away from electrical wiring or fatal electric shock may result.

## SYMBOLS

The labels on your tools and manual may show symbols. These represent important information about the product or instruction on its use.

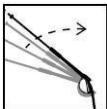
	Indicates a potential personal injury hazard.
	Do not expose to rain or use in damp locations.
	To reduce the risk of injury, user must read and understand operator' s manual before using this product.
	Always wear safety goggles or safety glasses with side shields and as necessary, a full-face shield when operating this product.

	<p>To reduce the risk of injection or injury, never direct a water stream towards people or pets or place any body part in the stream. Leaking hoses and fittings are also capable of causing injection injury.</p> <p>Do not hold hoses or fittings.</p>
	<p>To reduce the risk of injury from kickback, hold the spray lance securely with both hands when the machine is on.</p>

	<p>Failure to use in dry conditions and to observe safe practices can result in electric shock.</p>
	<p>Warning! Never point the gun to human, animals, the machine body, power supply or any electric appliances.</p>
	<p>Machine not intended to be connected to the potable water mains.</p>

	<p>This marking indicates that this product should not be disposed with other household wastes throughout the EU. To prevent possible harm to the environment or human health from uncontrolled waste disposal, recycle it responsibly to promote the sustainable reuse of material resources. To return your used device, please use the return and collection systems or contact the retailer where the product was purchased. They can take this product for environmentally safe recycling.</p> <p>The following applies to the German market:</p> <p>When purchasing a new device, you have the right to return the old device to your dealer. Dealers of electrical and electronic devices with a sales area of at least 400 square meters and food retailers with a sales area of at least 800 square meters who regularly sell electrical and electronic devices are obliged to take back old devices free of charge, even if you do not purchase a new device, if the dimension of the old device does not exceed 25 cm. The importer offers you return options directly in the shops and markets. Please also contact your dealer for information on local return options.</p> <p>If your old device contains personal data, you are responsible for deleting it before returning it.</p> <p>If this is possible without destroying the old device, remove the old batteries or rechargeable batteries and lamps before returning the old device for disposal and separate them for collection.</p> <p>If the batteries are permanently installed, indicate when disposing the device that it contains a battery.</p> <p>Contact your local municipality or city administration if you</p>
	<p>are looking for other ways to dispose of old devices.</p>

THIS EQUIPMENT MUST BE GROUNDED

In Malfunction or defect in the device is the ground the least resistance the current is reduced and thereby the risk of electric shock to the user. The AC power cord is connected to a suitable outlet be connected to all national standards and regulations regarding installation and grounding must comply. The operating voltage is the national power supply. If you are not sure whether the outlet is properly grounded, ask a qualified electrician or maintenance technician to check. Take no changes to the device plug. If a non-matching connector on unit be mounted, pls leave a suitable plug from a qualified electrician. Do not use this device with adapter plugs.

## USE OF EXTENSION CORDS

Use of an extension cord with this product is NOT RECOMMENDED. If you must use an extension cord, use only extension cords that are intended for outdoor use. These



cords are identified by a marking “ACCEPTABLE FOR USE WITH OUTDOOR APPLIANCES, STORE INDOORS WHILE NOT IN USE.” Use only extension cords having an electrical rating not less than the rating of the product. Examine extension cord before use. DO NOT USE DAMAGED EXTENSION CORDS! Do not pull the cord to disconnect from receptacle, always disconnect by pulling on plug. Keep cord away from heat and sharp edges. Always disconnect the extension cord from the receptacle before disconnecting the product from the extension cord.

WARNING - To reduce the risk of electrocution, keep all connections dry and off the ground. Do not touch the plug with wet hands.

- Do not use the appliance if a supply cord or important parts of the appliance are damaged, e.g. safety devices, high pressure hoses, trigger gun.
- If an extension cord is used, the plug and socket must be of watertight construction.
- WARNING: Inadequate extension cords can be dangerous
- Remove the plug from the socket-outlet during cleaning or maintenance and when replacing arts or converting the machine to another function.

## PROPER USE OF THE HIGH PRESSURE CLEANER

THIS UNIT IS INTENDED FOR USE WITH COLD WATER ONLY!  
DO NOT USE HOT WATER IN THIS PRESSURE CLEANER.

1. Operate the pressure cleaner at no more than the fluid pressure rated for the pressure cleaner. Never run the pressure cleaner without a water supply. Running the unit without a water supply will cause irreparable damage to the unit.
2. Make sure that the water supply you use for the pressure cleaner is not dirty, sandy, and does not hold any corrosive chemical products. Using a dirty water supply will compromise the long life of the pressure cleaner.
3. CAUTION - The pressure cleaner can be used for a variety of applications including washing cars, boats, patios, decks, garages etc. where high pressure is necessary to remove dirt and debris. High-pressure water flow can damage the work surface if not used properly! See the section titled “Operating Instructions” for more details. Always test the spray in an open area first.
4. NEVER move the unit by pulling on the high pressure hose. Use the handle provided on the top of the unit.
5. Always hold the high pressure gun and wand with two hands. Keep one hand on the gun/trigger, while supporting the wand with the other hand (see diagram).
6. When dispensing detergent, the pressure cleaner applies detergent to the cleaning area at low pressure only. Once the detergent has been applied, spray the detergent off of the work area by using the adjustable nozzle.

## ASSEMBLY INSTRUCTIONS

### Unpacking the Carton

After opening the carton, please remove all parts and check them against the following

list of components that are included:

- |                                      |                           |
|--------------------------------------|---------------------------|
| 1. Attachment holder                 | 8. Spray gun              |
| 2. 0° Quick- connect nozzle(red)     | 9. Cleaning pin           |
| 3. 15° Quick- connect nozzle(yellow) | 10. Water inlet connector |
| 4. 25° Quick- connect nozzle(green)  | 11. Spray wand            |
| 5. 40° Quick-Connect nozzle (white)  | 12. Detergent bottle      |
| 6. Short high pressure pipe          | 13. Power switch          |
| 7. High pressure hose                |                           |

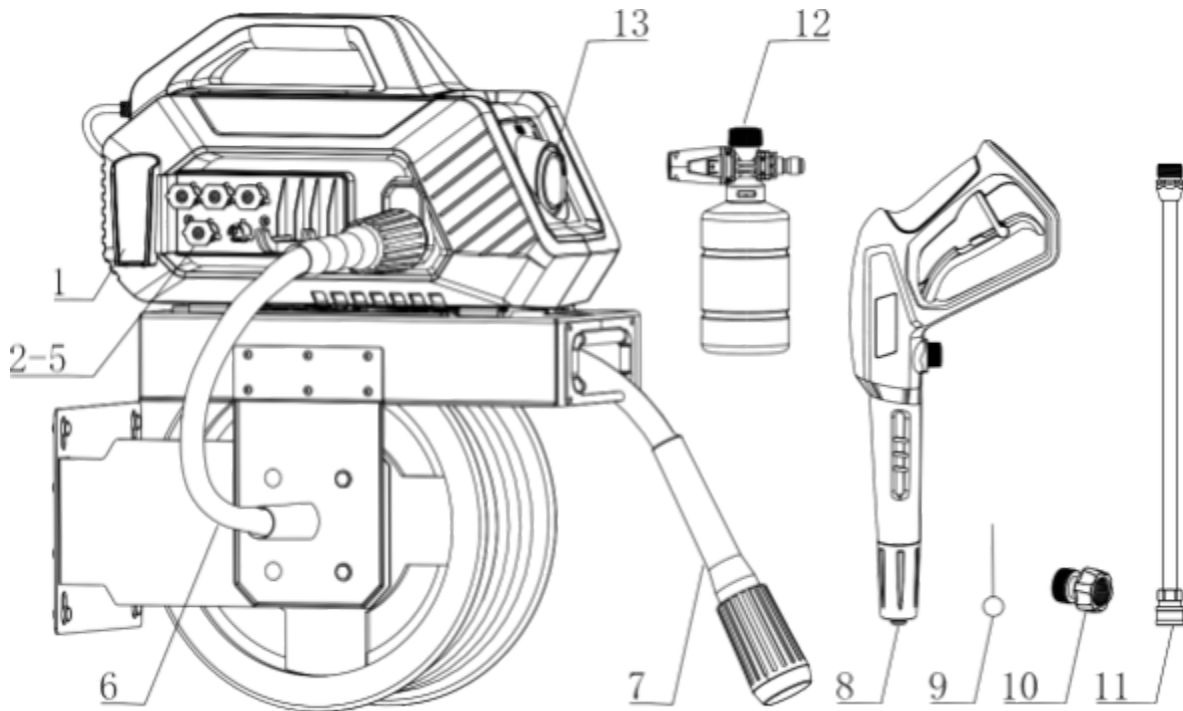

Due to transportation and packaging, some of the accessories may be supplied disassembled. Please follow the assembly instructions.

## Step 1

Ensure that the pump and the reel mounting bracket are properly aligned before installation. Place the pump in the designated mounting slot on the reel frame. Slide the pump assembly along the mounting track until it locks into position. Secure the pump using locking mechanisms to prevent movement. Verify that all mechanical interfaces are properly engaged and that the pump is seated correctly.

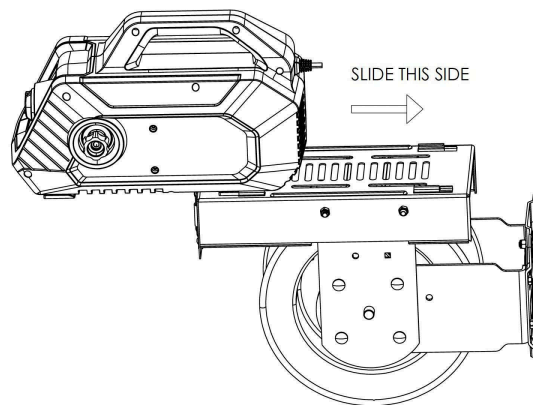

## Step 2

Screw the Attachment holder (1) to the main body as below fig. The screws will be packed together with

the main body, pls kindly check and find it when unpacked.

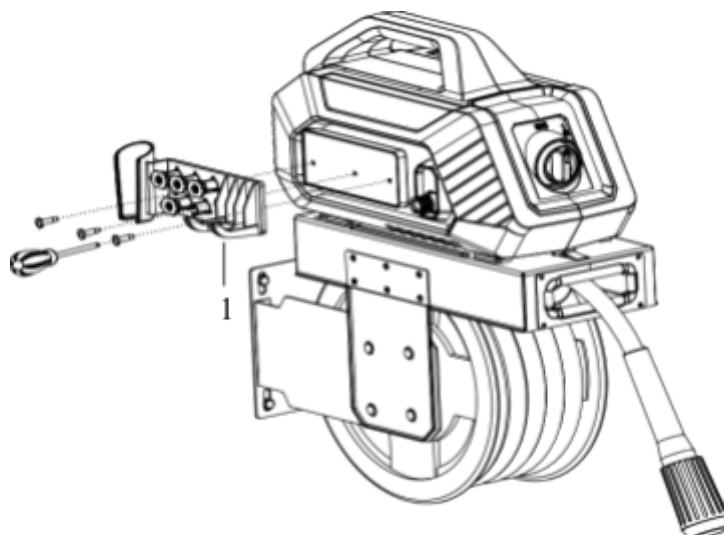

### Step 3

Insert Spray wand (15) into Spray gun (12) and turn Spray wand clockwise until locked in place.

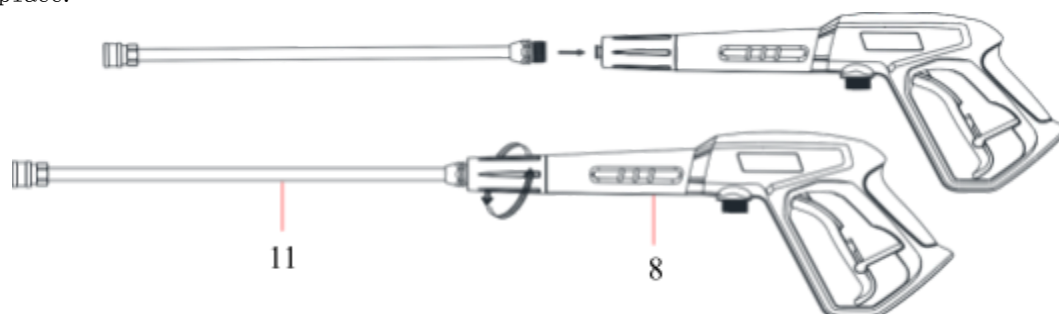

### Step 4

Connect the short high-pressure pipe (6) to the outlet pipe by simply tightening the high-pressure pipe joint onto the outlet pipe.

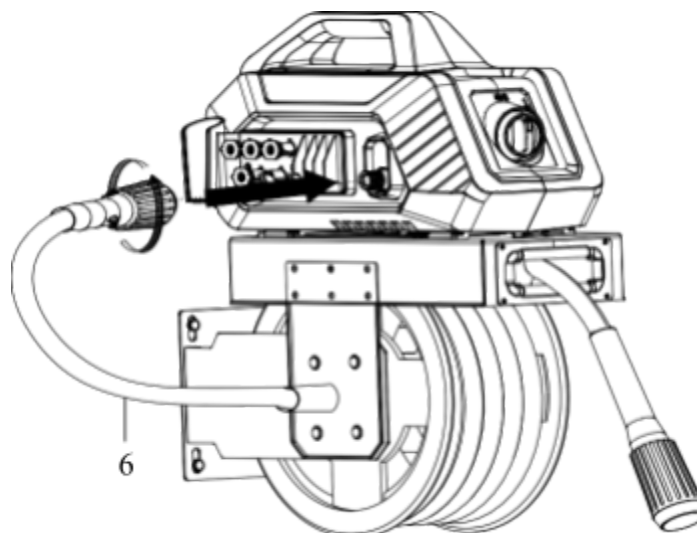

### Step 5

Attach the high pressure hose (5) to the gun (7).

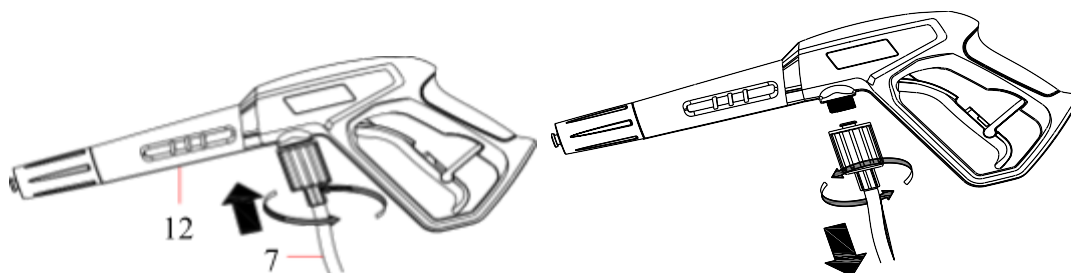

## Step 6

Attach the hose connector to pressure washer. Before attaching the connector to the male fitting, remove the plastic cap, which is inserted onto the male fitting on the pressure washer before shipping. This plastic cap can be discarded once removed. After both components have been installed, attach the garden hose with connector screw on the pressure washer. Connect the garden hose to the waterspout.

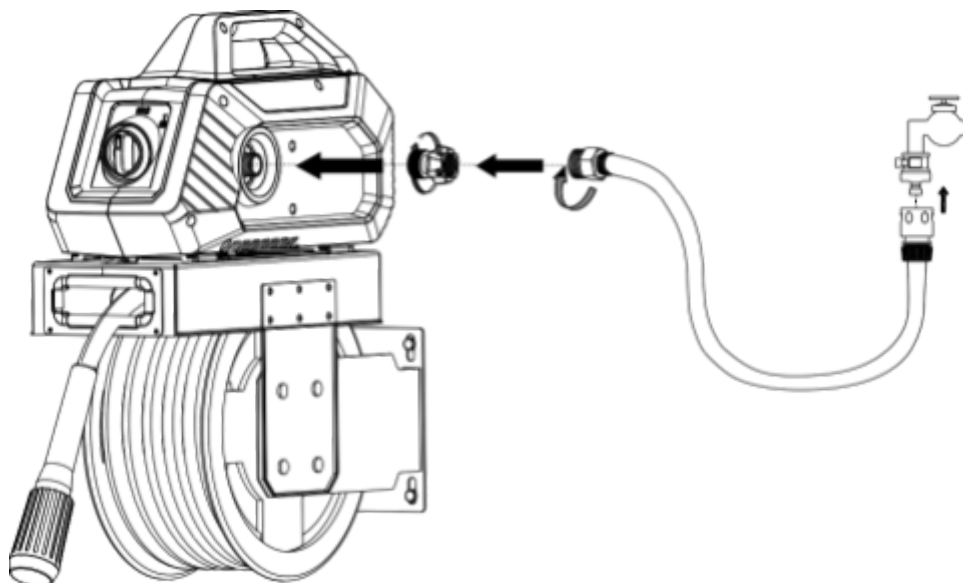

## OPERATING INSTRUCTIONS

THIS UNIT IS INTENDED TO BE USED WITH COLD WATER ONLY! DO NOT USE HOT WATER IN THIS PRESSURE CLEANER!

## Starting Up

After connecting the pressure cleaner to your cold water supply, proceed as follows:

- Make sure that the ON/OFF switch is in the OFF position.
- Connect the garden hose to the inlet fitting.
- Install the Attachment holder to the machine main body, as per assembly step #1.
- Insert the adjustable spray nozzle into the gun as per assembly step #2.
- Connect the Short high pressure pipe to the high pressure outlet fitting as per assembly step #3.
- Connect the high pressure hose to the gun, as per assembly step #4.
- Connect the garden hose to the high pressure washer inlet fitting as per assembly step #5.
- Open the water supply valve completely.
- Before turning the unit on, press the gun trigger to bleed all the remaining air out of the pump and hose.
- Start the pressure cleaner by turning the on/off switch to the on position and squeeze the trigger. REMINDER: Motor does not run continuously, only when the trigger is squeezed.

WARNING - RISK OF INJECTION! Unit will start spraying when trigger is squeezed. When turning the unit off after use, high pressure still exists inside the hose and unit. Point the gun in a safe direction and discharge the excess pressure. NEVER direct the high pressure water stream at people or animals.

## Automatic On/Off

The pressure cleaner is equipped with an automatic on/off switch. The pressure cleaner will only run when the power switch is in the ON position and the trigger on the gun is squeezed. When you release the trigger to stop spraying water through the gun, the motor on the pressure cleaner will automatically shut off. Simply squeeze the trigger again to resume using the cleaner. To stop using the pressure cleaner, release the trigger and switch the unit to the OFF position. The unit should be turned completely OFF while not in use or while unattended.

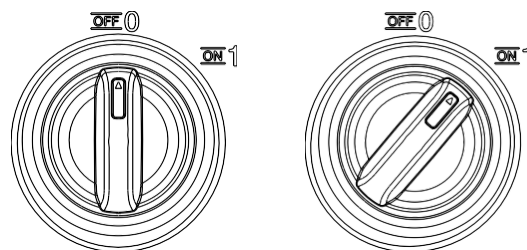

## Bleeding The Gun

It is very important to bleed the gun before using the pressure cleaner. Refer to the “Assembly Instructions” to assemble the pressure cleaner. To bleed the gun, simply

connect the garden hose to the pressure cleaner and squeeze the trigger BEFORE turning the electrical supply on. This allows any air trapped inside the pressure cleaner and gun to be removed before using the unit. Continue holding trigger for approximately one minute to allow any excess air out of the unit. Water will flow through the gun at low pressure during this procedure. For more bleeding tips, see the section titled “Operating Instructions.”

## Gun Safety Lock

This pressure cleaner is equipped with a gun trigger safety lock. When not in use, make sure Lock-off switch is in “Lock” position.

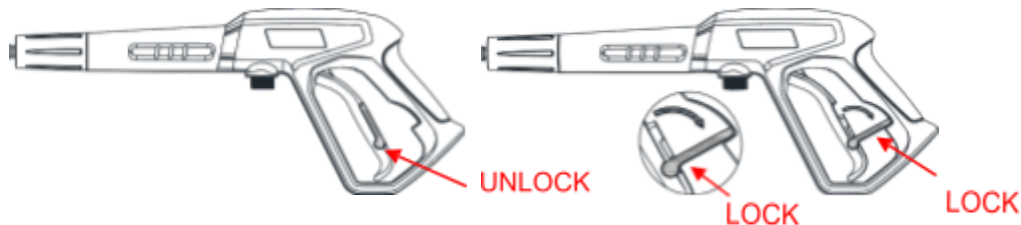

## Adjustable Spray Nozzle

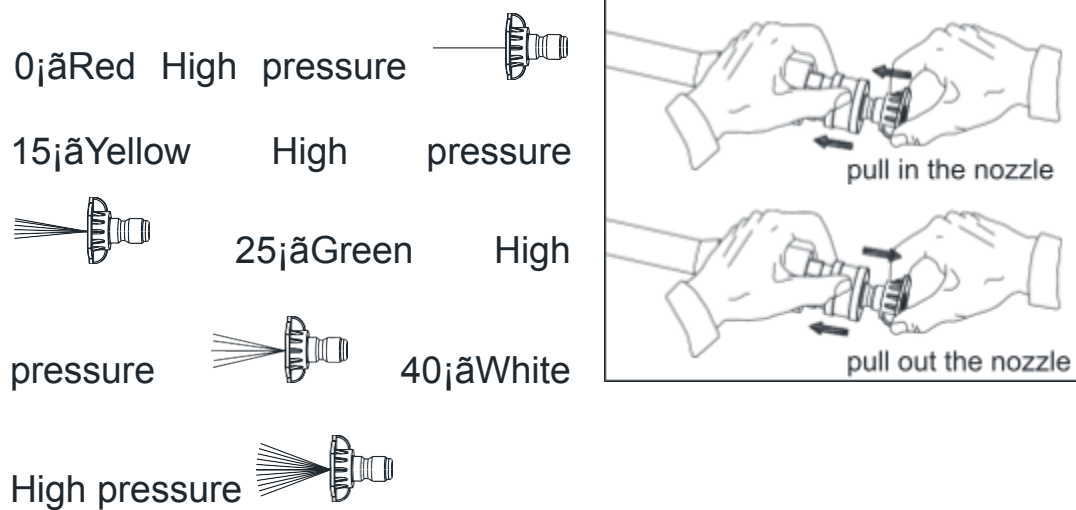

1. 0° nozzle, Red, Fine spot spray means delivering a high-pressure pencil-point jet stream. It is used to cut heavy dirt deposits in a small concentrated area. It is ideal for dissolving stubborn substances, like tar and grease spots on concrete, or for removing caked mud from equipment. It is also used to clean hard-to-reach areas including the facades of 2-story buildings or undersides of lawn mowers and tractors.
  2. 15° nozzle, Yellow, for intense cleaning jobs on hard surfaces that can withstand the high-pressure. Applications include stripping paint, removing oil stains, grease, heavy mildew stains, and rust from steel.
  3. 25° nozzle, Green, for cleaning home siding, brick patios, wood decks, driveways, sidewalks, cars or furniture.
  4. 40° nozzle, White, for cleaning items such as cars, trucks, boats, patio furniture, or lawn equipment.
- WARNING!** Remember to replace the nozzle when the gun is off, to ensure that they do not accidentally eject with force during removal.



Unblock lance

A clogged or partially clogged water filter or nozzle can cause significant reduction of water pressure coming out of the nozzle and /or cause the unit to pulsate while spraying.

1. The water filter was installed inside the water inlet quick connector, should be cleaned periodically. Rinse it with clean tap water, and then place it back into the water inlet quick connector.

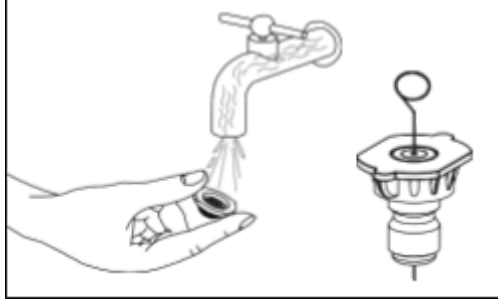

2. Using the nozzle tip cleaner provided (or an unfold paper clip), insert the wire into the nozzle hole and move back and forth until debris is dislodged. Back flush water through the nozzles using garden hose and highest pressure available (either standard water nozzle or use your thumb over the nozzle to create water pressure for back flush).

## USING DETERGENTS

THE PRESSURE CLEANER WILL DISPENSE DETERGENT AT LOW PRESSURE. USE THE ADJUSTABLE SPRAY NOZZLE TO RINSE CLEAN.

BIODEGRADABLE DETERGENTS ARE SPECIFICALLY FORMULATED TO PROTECT THE ENVIRONMENT AND YOUR PRESSURE CLEANER. THESE DETERGENTS WILL NOT CLOG THE FILTER AND WILL PROTECT THE INTERNAL PARTS OF THE PRESSURE CLEANER FOR A LONGER LIFE.

## Step 1

Separate the nozzle from the detergent container by turning the detergent reservoir counter clockwise and separating the two components. Fill the detergent container with approved detergent. Pour the detergent slowly into the reservoir using a funnel. Re-attach the two components by re-inserting the nozzle back onto the detergent reservoir and turning clockwise. To apply the detergent cleanser to your working area, attach the detergent nozzle to the gun. Turn the pressure cleaner switch to the ON position. Pull the trigger to operate the unit. The pressure cleaner will mix the detergent with water. Do not allow the detergent to dry on the object when you are cleaning.

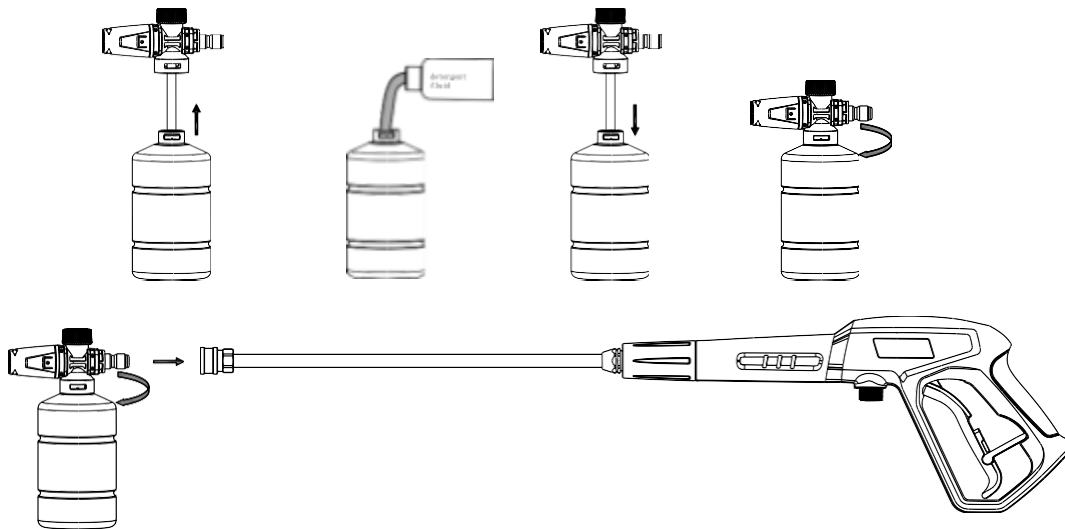

## Step 2

Adjust detergent size: Rotate in the “+” direction to increase detergent concentration, and rotate in the “-” direction to decrease detergent concentration.

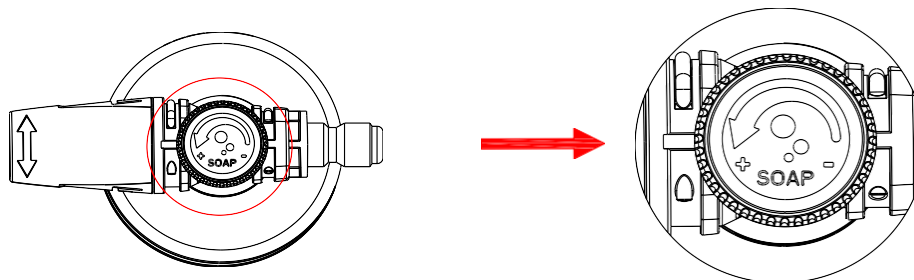

WARNING: NEVER USE PRODUCTS WITH BLEACH OR CHLORINE OR ANY OTHER CORROSIVE MATERIALS, INCLUDING LIQUIDS CONTAINING SOLVENTS (I.E. GAS, OILS ETC), TRI-SODIUM PHOSPHATE PRODUCTS, AMMONIA, OR ACID-BASED CLEANERS. THESE CHEMICALS WILL HARM THE UNIT AND CAUSE DAMAGE TO THE SURFACE BEING CLEANED. ALWAYS READ THE LABEL.

# CLEAN-UP AND STORAGE

## Shutting Down the Pressure Cleaner

WHEN FINISHED USING THE PRESSURE CLEANER,  
FOLLOW THESE STEPS TO SHUT  
DOWN THE UNIT:

- Turn the pressure cleaner to the OFF position.
- Turn off the water supply.
- Before disconnecting high-pressure hose connection, point the gun in a safe direction and discharge the high-pressure water.
- Disconnect high-pressure hose from the pressure cleaner and gun.
- Disconnect garden hose from the pressure cleaner.
- Remove quick coupler fitting from garden hose and attach to the nipple portion of the fitting installed on the pressure cleaner for storage.
- Remove excess water from the pump by tipping the unit on both sides to drain any remaining water from inlet and outlet fittings.
- Remove Water Intake Filter and flush with water to remove dirt or debris. Return filter once cleaned.
- Drain detergent reservoir and flush with running water.
- Wipe away any remaining water on all parts and fittings.
- Engage the gun safety lock.
- Store the pressure cleaner, parts, and accessories in an area with a temperature above 0° C (32° F).

## Winterizing and Long-Term Storage

FOLLOW ALL OF THE ABOVE SHUT-DOWN  
PROCEDURES, ADDING THE FOLLOWING STEPS...

- After disconnecting the water supply, and before disconnecting the high-pressure hose, turn the pressure cleaner on for 2-3 seconds, until any remaining water in the pump exits.

TURN UNIT OFF IMMEDIATELY.

CONTINUED USE OF THE PRESSURE CLEANER WITHOUT  
WATER SUPPLY ATTACHED WILL CAUSE  
SEVERE DAMAGE TO THE UNIT!

- Always store the pressure cleaner, parts, and accessories in an area with a temperature above 0° C (32° F).

WARNING: FAILURE TO COMPLY WITH THESE  
STORAGE INSTRUCTIONS WILL RESULT IN  
DAMAGE TO THE PUMP ASSEMBLY.

## Maintenance

- This pressure cleaner is supplied with a closed lubrication system, so no addition of oil is needed.
- Check all hoses and accessories for damage prior to use.
- Check the inlet filter periodically for deposits. Clean this filter regularly for maximum performance.

# CLEANING TIPS

WARNING: ALWAYS TEST THE SPRAY IN AN AREA FREE AND CLEAR OF PEOPLE AND OBJECTS BEFORE YOU SPRAY AT THE INTENDED CLEANING SURFACE.

## Wood and Vinyl Decks

Rinse deck and surrounding area with fresh water. If using detergent, fill the detergent reservoir and apply to the area being cleaned at low pressure. For the best, reduce your work area to smaller sections and clean each section one at a time. Allow the detergent to rest on the surface for a few minutes and then rinse at high pressure. Do not let the cleanser dry. Always clean from left to right and top to bottom for best results. Rinse at high pressure using the fan spray keeping the tip of the spray nozzle at least 6-9 inches from the cleaning surface. Maintain a further distance from the cleaning area when using a direct spray. Caution: For softer woods, increase the distance from the cleaning area.

## Cement Patios, Stone, and Brick

Rinse cleaning and surrounding area with fresh water. If using detergent, fill the detergent reservoir and apply to the area being cleaned at low pressure. Rinse at high pressure using the fan spray in a sweeping motion keeping the tip of the spray nozzle at least 3-6 inches from the cleaning surface. Maintain a further distance from the cleaning area when using a direct spray.

## Cars, Boats, and Motorcycles

Rinse cleaning and surrounding area with fresh water. If using detergent, fill the detergent reservoir and apply to the area being cleaned at low pressure. To achieve the best results, clean one side at a time. Allow the detergent to rest on the surface for a few minutes, but do not let the detergent dry. Rinse at high pressure using the fan spray in a sweeping motion keeping the tip of the spray nozzle at least 8 inches from the cleaning surface. Maintain a further distance from the cleaning area when using a direct spray. Wipe surface dry for a polished finish.

## Barbecue Grills, Power Equipment, and Garden Tools

Rinse cleaning and surrounding area with fresh water. If using detergent, fill the detergent reservoir and apply to the area being cleaned at low pressure. Allow the detergent to rest on the surface for a few minutes, but do not let the detergent dry. Rinse at high pressure using the fan spray keeping the tip of the spray nozzle at least 1-3 inches from the cleaning surface. Maintain a further distance from the cleaning area when using a direct spray.

## TECHNICAL DATA

Model	C605i-2100
Mains voltage	220V
Mains frequency	50Hz
Power input	2100 W
Rated pressure	120bar
Max. pressure	180bar
Rated flow	7 L/min
Max water inlet pressure	12bar
Max water inlet temperature	50°C

Level of sound pressure measured  
according to ISO 3744:

$L_{PA}$  (sound pressure) dB (A) 90.3

$K_{PA}$  (sound pressure) dB (A) 3

$L_{WA}$  (sound power) dB (A) 105

$K_{WA}$  (sound power) dB (A) 3

Weighted root mean square acceleration value: < 2.65 m/s<sup>2</sup>

### GUARANTEE

Refer to the enclosed guarantee conditions for the terms and conditions of guarantee.

### ENVIRONMENT

Should your machine need replacement after extended use, do not put it in the domestic waste but dispose of it in an environmentally safe way.

# TROUBLESHOOTING TIPS

WHEN THE SWITCH IS IN THE “I” POSITION THE MACHINE WILL NOT START

PROBABLE CAUSE

Electrical socket is faulty  
Voltage is inadequate  
adequate  
Power cord is not plugged in

SOLUTION

Check plug, socket, fuses  
Check whether the voltage is  
adequate  
Plug in power cord

THE PUMP DOES NOT REACH ADEQUATE PRESSURE OR FLUCTUATES

PROBABLE CAUSE

Water inlet filter is clogged  
Pump is drawing air  
Suction valves are clogged/worn  
Diameter of garden hose too small  
Water supply is restricted  
Insufficient water supply

SOLUTION

Remove and clean filter  
Tighten connections/bleed system  
Clean or replace valves  
Replace with ¾ inch garden hose  
Check hose for kinks or leaks  
Fully open water source

THE PRESSURE CLEANER HAS OR WILL NOT MAINTAIN PRESSURE

PROBABLE CAUSE

Excessive air in waterline and pump

SOLUTION

Turn unit and water supply off/  
Bleed system/Hold trigger down

THE PRESSURE CLEANER MAKES EXCESSIVE NOISE PROBABLE

CAUSE

Intake is blocked  
Valves are worn, dirty, or clogged  
Filter is dirty

SOLUTION

Check the intake valves  
Check, clean or replace valves  
Check, clean, or replace filter

THE MOTOR STOPS RUNNING WHILE IN USE

PROBABLE CAUSE

Net voltage lower than suggested  
adequate

SOLUTION

Check whether the voltage is  
adequate

# EC Declaration of Conformity

We hereby declare that the design, construction and the model for the device with the standard and the requirements of safety and health of the EU's consistent policy. The statement will prove ineffective if the device is being modified without our approval.

Type of instrument: Pressure Cleaner C605i-2100

Anwendbar EU guidelines:

- EU Machinery Directive 2006/42/EC
- EU Low Voltage 2006/95/EC
- EU Directive Electromagnetic Compatibility 2004/108/EC
- EU Electromagnetic Compatibility Directive 2000/14/EC
- EU Directive 2002/95/EC

Applied harmonized standards:

- EN 60335-1: 2012/A15:2021
- EN 60335-2-79:2012
- EN 55014-1:2021
- EN 55014-2:2021
- EN IEC 61000-3-2:2019/A1:2021
- EN 61000-3-3:2013/A2:2021
- EN 62233:2008